

Crossheads for Doors and Windows

INSTALLATION INSTRUCTIONS

MATERIALS NEEDED

- Safety Glasses
- Tape Measure
- Hammer or Pneumatic Nailer
- Handsaw
- Nail Countersink
- Corrosion-resistant Finishing Nails or Screws
- Caulk Gun
- PL Premium Adhesive
- Caulk or Wood Filler
- Sandpaper
- Pencil
- Latex or Oil Base Paint



All Fypon door and window Crossheads are measured from and ordered in relationship to the Breastboard dimension.

Crosshead widths are available in the following options:

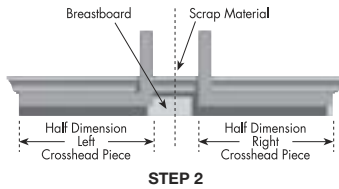

SPECIAL MADE FABRICATION

Fypon can provide custom Crossheads in one piece when the requested size is smaller than the largest standard size. Widths larger than the largest standard size will ship in two or more pieces. **See price book for information on ordering special crossheads.**

CUSTOM WIDTHS CREATED ON THE JOB

1. To customize widths on the job, order your Crosshead in a stock oversized width.
2. Take the desired width of the Crosshead, divide the dimension in half. This measurement represents the width of each side of the Crosshead. Next, measure from the right of the Crosshead breastboard the "half" dimension. Mark the measurement using a pencil and framing square. Do the same from the left side of the Crosshead breastboard. Cut the Crosshead at the pencil marks. The center portion of the Crosshead will be scrap material.
3. Place the right and left Crosshead pieces on top of the entrance opening, aligning the outer edge of the Crosshead breastboard with the outer edge of the entrance opening or Pilasters. Securely fasten each Crosshead through the breastboard using PL Premium Adhesive and the necessary fasteners.
4. To cover the seam at the center of the Crosshead, overlay the Keystone onto the Crosshead and center it over the opening. Fasten the Keystone to the Crosshead using PL Premium Adhesive and fasteners. Countersink fastener holes, and fill for a finished look.

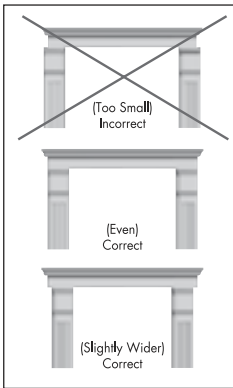
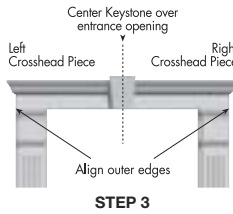

NOTE: It is architecturally acceptable to install Crossheads slightly wider than the opening as long as the overhang is even on both sides.

USING CORROSION-RESISTANT FASTENERS AND PL PREMIUM ADHESIVE

Always use corrosion-resistant mechanical fasteners (nails or screws) and PL Premium Adhesive when installing Fypon products. This combination provides a secure, long lasting bond. Countersink all fasteners about 1/8 inch and fill with exterior grade white spackle. If desired, sand any minor imperfections and topcoat with a quality exterior latex or oil base paint. Fypon exterior millwork installations should be finished using a quality, exterior grade silicone caulk to prevent water infiltration behind siding, windows and doors. Some exterior millwork installations, in particular new construction (before siding is applied) may require a J-channel and/or flashing to prevent water infiltration. Installers must determine which installation technique is best for the specific situation.

IMPORTANT:

Please read these installation guidelines thoroughly before beginning installation. Please note that these guidelines are provided only to assist with the installation of Fypon mouldings and millwork products. Modified procedures may be required in order to meet specific situations, unique applications and local building codes. The manufacturer does not under any circumstances warrant the installation of its products. Be sure to wear appropriate protective clothing, gloves and safety glasses when working with any tools. Installer should check for and relocate all electrical wiring within the proposed installation area, as needed (be sure to disconnect all electric power before working with any electrical wiring and follow all applicable local electrical codes and safety procedures).

GENERAL INFORMATION

Before installation, please keep in mind that Fypon products:

- Should be used for decorative purposes only, not to provide structural support (except Structural Columns, Balustrade Systems and Porch Posts).
- Should never be installed with mechanical fasteners only. For best results always use non-corrosive fasteners along with urethane base PL Premium Adhesive.
- Are easy to repair. Use wood filler or automotive filler to quickly fill dents or gashes of any size. Broken moulding can be successfully rejoined with urethane base PL Premium Adhesive.
- Should not be stored in extreme heat. Acclimate before installation. Due to urethane's high insulating value, this may take up to 10 hours.
- Will resist the elements, except for direct sunlight to the yellowish (unpainted) underside of the millwork. It is important to fill damaged or cut surfaces with putty, caulk, and/or paint within a few days.
- Can withstand temperatures of about 140°F (60°C). However, the millwork should never be placed in an area subject to solar temperature buildup, such as behind a storm door.
- Can be used safely in accordance with SBCCI, BOCA, CABO and NFPA rulings. There are no official independent laboratory fire test results for Fypon products. The products are equivalent to any decorative urethane products not specifically formulated for fire resistance.
- May require altered installation procedures to meet local specifications. Check local building codes.

The installation suggestions in this catalog are to be used only as a guideline. Fypon, Ltd. assumes no liability for any damages, including but not limited to personal, property, incidental, or consequential damages, resulting from the installation of its products. Fypon, Ltd.'s sole responsibility in connection with the sale and installation of its products is the limited warranty set forth below.

FYPON LIMITED WARRANTY

Fypon, Ltd. warrants to the original consumer purchaser that our exterior white primer paint finish will be free from UV ray degradation, blistering, and paint peeling under normal use for a period of one (1) year from the date of purchase.

We further provide a LIFETIME WARRANTY to the original purchaser on the urethane material. This LIFETIME WARRANTY provides that the urethane material will be free from defects in material and workmanship under normal use.

If a defect is found in a Fypon product and the above conditions have been met, a customer should notify Fypon in writing within thirty (30) days of discovering the defect. The customer may be required to return the product to Fypon (at his or her expense) for evaluation. Fypon will then review the situation and determine if replacement, repair or refund of the product is appropriate. This warranty does not include labor, transportation costs or any other expenses of any kind incurred in connection with the purchase, use or installation of the product. Replacement, repair or refund is the sole and exclusive option under this limited warranty.

This limited warranty does not cover damage resulting from mishandling in transit (if within the customer's control), acts of God, customer alteration, vandalism, misuse, abuse, improper maintenance, unreasonable care or other causes not arising from defects in workmanship and materials. THERE ARE NO WARRANTIES, EXPRESS OR IMPLIED, WRITTEN OR ORAL, INCLUDING ANY WARRANTIES OF MERCHANTABILITY OR FITNESS FOR PURPOSE, OTHER THAN AS EXPRESSED HEREIN. No person, agent, distributor, dealer, service facility, or company is authorized to change, modify or amend the terms of this limited warranty in any manner or fashion whatsoever, except to the extent provided in this limited warranty. Fypon, Ltd. shall not be liable to the customer or to any other person for any incidental or consequential damages or loss of profit resulting from any defect in the product.

Some states do not allow limitations on how long an implied warranty lasts, or the exclusion or limitation of incidental or consequential damages, so that the above limitation or exclusion may not apply. This warranty gives you specific legal rights. You may also have other rights which vary from state to state.

Remodeling - General Instructions

TECHNIQUES FOR VINYL, ALUMINUM AND STEEL SIDINGS

When remodeling, Fypon products can be installed over existing exterior siding. Always assess the wall area where the millwork will be positioned.

If there is solid sheathing or framing behind the siding, Fypon products should be secured to it. However, if solid material cannot be located, use hollow wall fasteners.

Millwork can be placed flush against existing brickmoulding. Apply PL Premium Adhesive along with noncorrosive fasteners to securely fasten to the sidewall surface.

Tip: We suggest using screws when securing millwork over siding. The extra holding strength of the screws along with PL Premium adhesive will secure millwork in place.

INFORMATION ABOUT VINYL SIDING

Fypon products may be fastened directly on top of existing vinyl siding. However, since vinyl siding expands and contracts with temperature changes, a few extra steps are necessary to prevent the vinyl siding from buckling behind the millwork.

1. Position the millwork, then drill several small pilot holes through the millwork into the vinyl siding.
2. Remove the millwork and enlarge the pilot holes in the vinyl siding to approximately three times the diameter of the screw. This provides room for siding to expand and contract.
3. Caulk the drilled holes in the siding to prevent moisture migration behind the vinyl siding.
4. Next, apply a good quality, flexible construction adhesive to the back of the millwork. This type of adhesive allows the vinyl siding to flex, yet bonds the millwork securely to the vinyl siding surface. We recommend a flexible construction adhesive for this application.
5. Reposition the millwork and screw into the center of each drilled hole. Fill countersunk fastener holes with plastic wood filler. Sand filled holes smooth and touch up with paint.

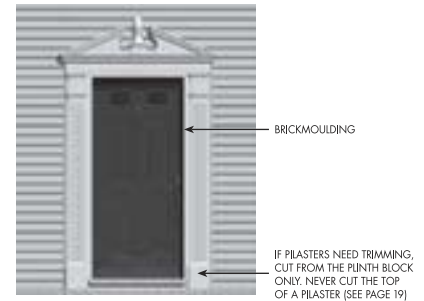
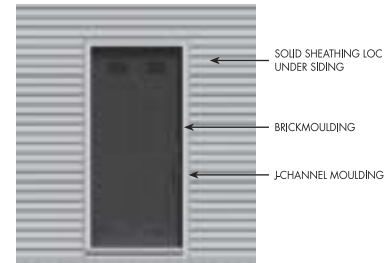

USING CORROSION-RESISTANT FASTENERS AND PL PREMIUM ADHESIVE

Always use corrosion-resistant mechanical fasteners (nails or screws) and PL Premium Adhesive when installing Fypon products. This combination provides a secure, long lasting bond. Countersink all fasteners about 1/8 inch and fill with exterior grade white spackle. If desired, sand any minor imperfections and topcoat with a quality exterior latex or oil base paint. Fypon exterior millwork installations should be finished using a quality, exterior grade silicone caulk to prevent water infiltration behind siding, windows and doors. Some exterior millwork installations, in particular new construction (before siding is applied) may require a J-channel and/or flashing to prevent water infiltration. Installers must determine which installation technique is best for the specific situation.

IMPORTANT:

Please read these installation guidelines thoroughly before beginning installation. Please note that these guidelines are provided only to assist with the installation of Fypon mouldings and millwork products. Modified procedures may be required in order to meet specific situations, unique applications and local building codes. The manufacturer does not under any circumstances warrant the installation of its products. Be sure to wear appropriate protective clothing, gloves and safety glasses when working with any tools. Installer should check for and relocate all electrical wiring within the proposed installation area, as needed (be sure to disconnect all electric power before working with any electrical wiring and follow all applicable local electrical codes and safety procedures).

Remodeling - General Instructions

TECHNIQUES FOR HARDBOARD AND WOOD SIDINGS

Fypon products may be installed directly over hardboard and wood siding.

PILASTERS

When installing Pilasters, measure the distance from the landing floor to the top of the brickmoulding. The Pilaster height should be cut at 3/16" longer than the top of the brickmoulding.

Apply PL Premium Adhesive around the top and side edges of the Pilasters. Do not apply adhesive to the bottom edge. The bottom edge should remain open to allow moisture to seep out. Next, position the Pilasters and fasten with noncorrosive fasteners.

TIP: We suggest using screws when securing the millwork over the siding. The extra holding strength of the screws along with the adhesive will secure the millwork in place.

CROSSHEADS

1. When installing Crossheads, it is important to apply vertical strips of vinyl undersill finish trim to prevent moisture from collecting behind the millwork. Trapped water will deteriorate the surface of the wood or hardboard siding. Use PL Premium Adhesive and galvanized roofing nails to secure the undersill strips vertically every 16" - 24" to the back of the Crosshead.
2. To install a Crosshead, apply PL Premium Adhesive to the back of the vertical undersill strips.
3. Position the Crosshead directly above the Pilasters (which will also be 3/16" above the top of the brickmoulding to allow moisture to escape). Fasten Crosshead in place using PL Premium Adhesive and noncorrosive fasteners.
4. Countersink fasteners with a non-shrinking filler and allow to dry. Sand filled holes and touch up with paint.

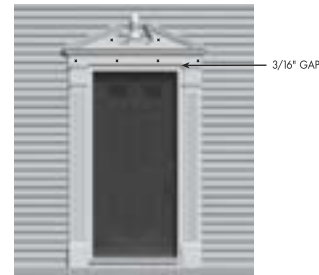
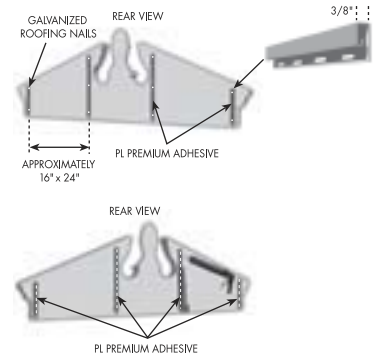
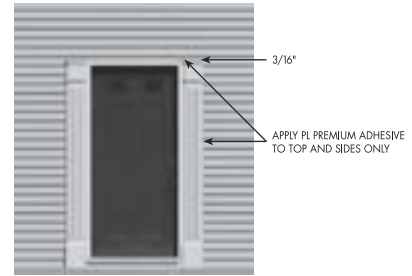

TIP: We suggest using screws when securing the Crosshead over hardboard siding materials. The extra holding strength of the screws along with the adhesive will secure the Crosshead in place.

USING CORROSION-RESISTANT FASTENERS AND PL PREMIUM ADHESIVE

Always use corrosion-resistant mechanical fasteners (nails or screws) and PL Premium Adhesive when installing Fypon products. This combination provides a secure, long lasting bond. Countersink all fasteners about 1/8 inch and fill with exterior grade white spackle. If desired, sand any minor imperfections and topcoat with a quality exterior latex or oil base paint. Fypon exterior millwork installations should be finished using a quality, exterior grade silicone caulk to prevent water infiltration behind siding, windows and doors. Some exterior millwork installations, in particular new construction (before siding is applied) may require a J-channel and/or flashing to prevent water infiltration. Installers must determine which installation technique is best for the specific situation.

IMPORTANT:

Please read these installation guidelines thoroughly before beginning installation. Please note that these guidelines are provided only to assist with the installation of Fypon mouldings and millwork products. Modified procedures may be required in order to meet specific situations, unique applications and local building codes. The manufacturer does not under any circumstances warrant the installation of its products. Be sure to wear appropriate protective clothing, gloves and safety glasses when working with any tools. Installer should check for and relocate all electrical wiring within the proposed installation area, as needed (be sure to disconnect all electric power before working with any electrical wiring and follow all applicable local electrical codes and safety procedures).

New Construction - General Instructions

TECHNIQUES FOR VINYL, ALUMINUM AND STEEL SIDINGS

1. For a new construction exterior, always prepare the area so Fypon products can be fastened securely to the sidewall surface. Apply plywood or oriented strandboard (OSB) sheathing where the millwork will be installed.

1a. Apply a moisture-resistant house wrap material to the sheathing material as per the manufacturers recommendations before installing millwork.

2. On the back of both Pilasters, apply a 1/4" bead of PL Premium Adhesive around the perimeter. Place Pilasters in position (right Pilaster on right side, etc.), aligning the edges of the Pilasters flush with the top and sides of the brickmoulding. Fasten millwork using PL Premium Adhesive and non-corrosive fasteners.

NOTE: If Pilasters need trimming, cut from the base only. Never cut the top of a Pilaster.

IMPORTANT: If a storm door is being installed — keep the brickmould in place and mount the storm door securely to the wooden brickmoulding. However, if desired and a storm door is not to be installed, the wooden brickmould material may be removed.

3. After installing the Pilasters, if the pilasters are not routed, butt and fit the siding manufacturer's recommended J-channel mouldings to the sides of the Pilasters and the top of the doorway. Install siding into J-channels, completely surrounding the doorway.

NOTE: Try to avoid placing siding lap joints above the doorway where a Crosshead may be positioned. This will eliminate any chance of moisture collecting behind the Crosshead and migrating into the sheathing material behind the Crosshead.

4. Due to the complexity of cutting and fitting flashing and siding to irregular shapes such as Crossheads, apply PL Premium Adhesive to the back of millwork, then position **DIRECTLY OVER** siding and securely fasten with noncorrosive fasteners. Any moisture that migrates behind the Crosshead will be flashed away by the J-channel trim installed in Step 3.

TIP: We suggest using screws when securing millwork **OVER SIDING** materials. The extra holding strength of the screws along with the PL Premium Adhesive will securely hold the Crosshead in place.

Important: When applying Crossheads over vinyl siding see information on Page 10, "Important Information About Vinyl Siding."

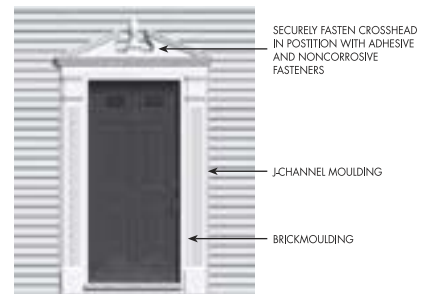
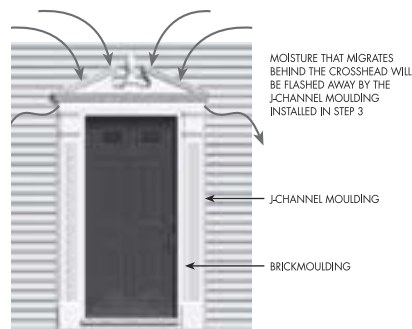
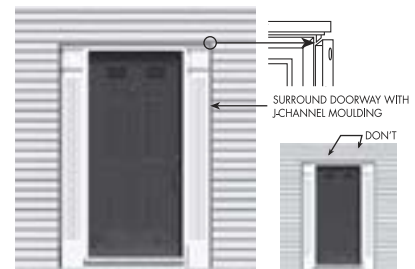
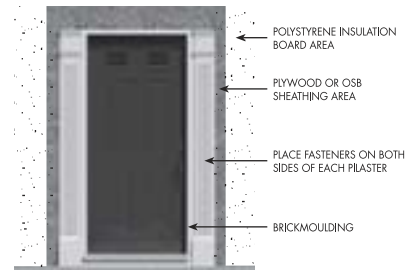
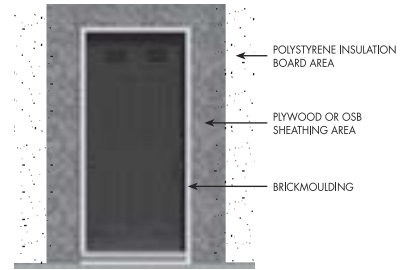

USING CORROSION-RESISTANT FASTENERS AND PL PREMIUM ADHESIVE

Always use corrosion-resistant mechanical fasteners (nails or screws) and PL Premium Adhesive when installing Fypon products. This combination provides a secure, long lasting bond. Countersink all fasteners about 1/8 inch and fill with exterior grade white spackle. If desired, sand any minor imperfections and topcoat with a quality exterior latex or oil base paint. Fypon exterior millwork installations should be finished using a quality, exterior grade silicone caulk to prevent water infiltration behind siding, windows and doors. Some exterior millwork installations, in particular new construction (before siding is applied) may require a J-channel and/or flashing to prevent water infiltration. Installers must determine which installation technique is best for the specific situation.

IMPORTANT:

Please read these installation guidelines thoroughly before beginning installation. Please note that these guidelines are provided only to assist with the installation of Fypon mouldings and millwork products. Modified procedures may be required in order to meet specific situations, unique applications and local building codes. The manufacturer does not under any circumstances warrant the installation of its products. Be sure to wear appropriate protective clothing, gloves and safety glasses when working with any tools. Installer should check for and relocate all electrical wiring within the proposed installation area, as needed (be sure to disconnect all electric power before working with any electrical wiring and follow all applicable local electrical codes and safety procedures).

New Construction - General Instructions

TECHNIQUES FOR HARDBOARD AND WOOD SIDINGS

For a new construction exterior, always prepare the area so the Fypon products can be fastened securely to the sidewall surface. Apply plywood or oriented strand board (OSB) sheathing where the millwork will be installed.

Apply a moisture-resistant house wrap material to the sheathing material as per the manufacturers recommendations before installing millwork.

PILASTERS

On the back of both Pilasters, apply a 1/4" bead of PL Premium Adhesive around the outside perimeter. Place Pilasters in position (right Pilaster on right side, etc.), aligning the edges of the Pilasters flush with the top and sides of the brickmoulding. Fasten millwork using PL Premium Adhesive and noncorrosive fasteners.

NOTE: If Pilasters need trimming, cut from the base only. Never cut the top of a Pilaster.

IMPORTANT: If a storm door is being installed — keep the brickmould in place and mount the storm door securely to the wooden brickmoulding. However, if desired and a storm door is not to be installed, the wooden brickmould material may be removed.

CROSSHEADS

To prevent water entry behind the millwork, all window or door Crossheads must be flashed, preferably with metal flashing. This is standard building construction. Do not caulk behind the Crosshead in lieu of flashing.

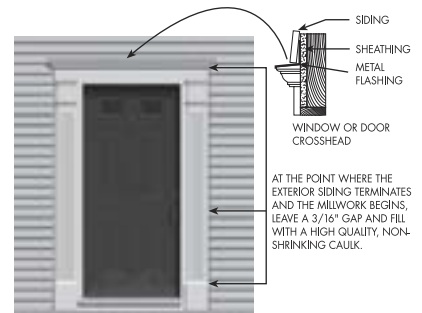
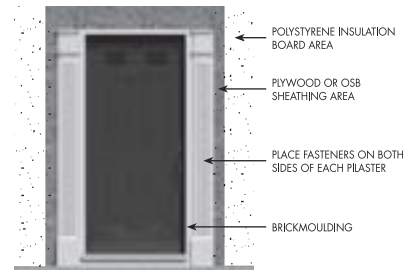
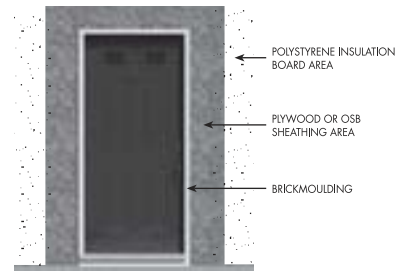

USING CORROSION-RESISTANT FASTENERS AND PL PREMIUM ADHESIVE

Always use corrosion-resistant mechanical fasteners (nails or screws) and PL Premium Adhesive when installing Fypon products. This combination provides a secure, long lasting bond. Countersink all fasteners about 1/8 inch and fill with exterior grade white spackle. If desired, sand any minor imperfections and topcoat with a quality exterior latex or oil base paint. Fypon exterior millwork installations should be finished using a quality, exterior grade silicone caulk to prevent water infiltration behind siding, windows and doors. Some exterior millwork installations, in particular new construction (before siding is applied) may require a J-channel and/or flashing to prevent water infiltration. Installers must determine which installation technique is best for the specific situation.

IMPORTANT:

Please read these installation guidelines thoroughly before beginning installation. Please note that these guidelines are provided only to assist with the installation of Fypon mouldings and millwork products. Modified procedures may be required in order to meet specific situations, unique applications and local building codes. The manufacturer does not under any circumstances warrant the installation of its products. Be sure to wear appropriate protective clothing, gloves and safety glasses when working with any tools. Installer should check for and relocate all electrical wiring within the proposed installation area, as needed (be sure to disconnect all electric power before working with any electrical wiring and follow all applicable local electrical codes and safety procedures).

Installing Siding Around Irregular Shaped Trim

FOR BOTH NEW CONSTRUCTION AND REMODELING APPLICATIONS

TECHNIQUES FOR HARDBOARD AND WOOD SIDINGS

NOTE: To prevent moisture infiltration, use house wrap as per the manufacturer's recommendations.

PILASTERS

Fasten the millwork directly to the house-wrapped sheathing using PL Premium Adhesive and noncorrosive fasteners. To prevent water entry behind the top of the brickmoulding, flash the top of the brickmoulding and pilasters.

Next, install exterior siding. At the point where the exterior siding terminates and the pilasters begin, leave a 3/16" gap and fill with a high quality, non-shrinking caulk.

IRREGULAR SHAPED CROSSHEADS

When installing irregular shaped Crossheads, it is important to apply vertical strips of vinyl undersill finish trim to prevent moisture from collecting behind the millwork. Trapped water will deteriorate the surface of the wood or hardboard siding. Use PL Premium Adhesive and galvanized roofing nails to secure the undersill strips vertically every 16"- 24" to the back of the Crosshead.

Position the Crosshead 3/16" above the top of the brick-moulding to allow any moisture that might collect to escape. Next, securely fasten the Crosshead in place using PL Premium Adhesive and non-corrosive fasteners.

Finally, countersink fasteners and fill with plastic wood filler. Sand flush and touch up with paint.

TIP: We recommend using screws when securing the Crosshead over the siding material. The extra holding strength of the screws along with the adhesive will securely hold the Crosshead in place.

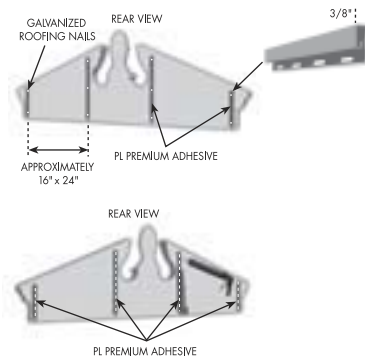
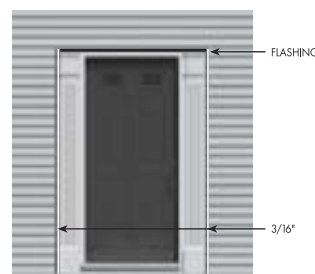
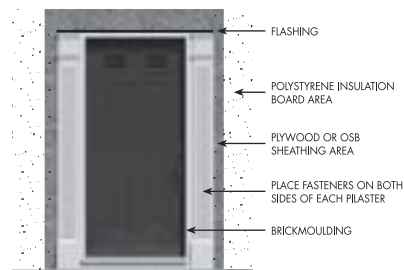

USING CORROSION-RESISTANT FASTENERS AND PL PREMIUM ADHESIVE

Always use corrosion-resistant mechanical fasteners (nails or screws) and PL Premium Adhesive when installing Fypon products. This combination provides a secure, long lasting bond. Countersink all fasteners about 1/8 inch and fill with exterior grade white spackle. If desired, sand any minor imperfections and topcoat with a quality exterior latex or oil base paint. Fypon exterior millwork installations should be finished using a quality, exterior grade silicone caulk to prevent water infiltration behind siding, windows and doors.

Some exterior millwork installations, in particular new construction (before siding is applied) may require a J-channel and/or flashing to prevent water infiltration. Installers must determine which installation technique is best for the specific situation.

IMPORTANT:

Please read these installation guidelines thoroughly before beginning installation. Please note that these guidelines are provided only to assist with the installation of Fypon mouldings and millwork products. Modified procedures may be required in order to meet specific situations, unique applications and local building codes. The manufacturer does not under any circumstances warrant the installation of its products. Be sure to wear appropriate protective clothing, gloves and safety glasses when working with any tools. Installer should check for and relocate all electrical wiring within the proposed installation area, as needed (be sure to disconnect all electric power before working with any electrical wiring and follow all applicable local electrical codes and safety procedures).

Synthetic Stucco Applications

EIFS – EXTERIOR INSULATION AND FINISH SYSTEM

When installing Fypon products over an existing synthetic stucco (EIFS) surface, it is important to seal out any moisture that could collect and pool between the millwork and the synthetic stucco surface. Moisture will not harm the Fypon product; however, the surface of the synthetic stucco is susceptible to prolonged moisture pooling.

To prevent moisture problems, a high quality adhesive/sealant must be used. This type of adhesive/sealant not only bonds the millwork securely to the EIFS wall surface, but also creates a seal/gasket to prevent moisture entry behind the millwork.

1. Apply a solid bead of adhesive/sealant near the outside edge of the top and sides of the millwork. The bottom edge of the millwork should remain free of adhesive/sealant to allow moisture to escape.
2. Assess the area where the millwork will be positioned. If there is solid sheathing or framing behind the EIFS surface, millwork should be secured directly to it. However, if solid material cannot be located, the use of hollow wall fasteners will be needed. Fasteners should be kept inside the bead of adhesive/sealant.
3. When the millwork is placed snug against the wall surface, the bead of adhesive/sealant might ooze out the edges. Smooth out the bead and add additional adhesive/sealant to create a good weather proof seal that will repel water.

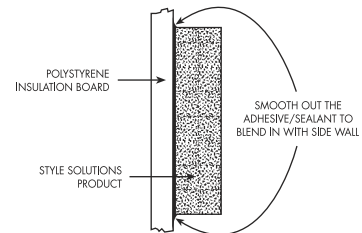
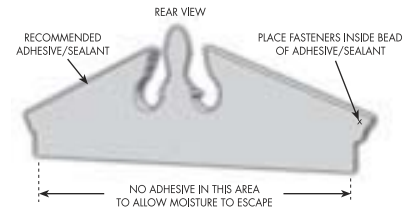
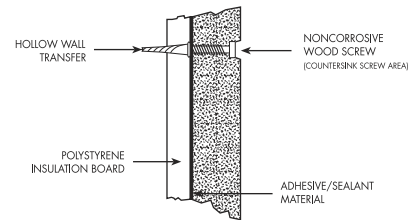
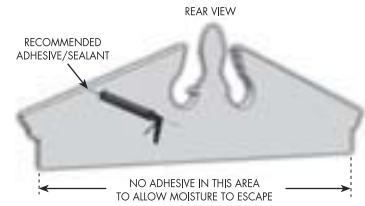

USING CORROSION-RESISTANT FASTENERS AND PL PREMIUM ADHESIVE

Always use corrosion-resistant mechanical fasteners (nails or screws) and PL Premium Adhesive when installing Fypon products. This combination provides a secure, long lasting bond. Countersink all fasteners about 1/8 inch and fill with exterior grade white spackle. If desired, sand any minor imperfections and topcoat with a quality exterior latex or oil base paint. Fypon exterior millwork installations should be finished using a quality, exterior grade silicone caulk to prevent water infiltration behind siding, windows and doors. Some exterior millwork installations, in particular new construction (before siding is applied) may require a J-channel and/or flashing to prevent water infiltration. Installers must determine which installation technique is best for the specific situation.

IMPORTANT:

Please read these installation guidelines thoroughly before beginning installation. Please note that these guidelines are provided only to assist with the installation of Fypon mouldings and millwork products. Modified procedures may be required in order to meet specific situations, unique applications and local building codes. The manufacturer does not under any circumstances warrant the installation of its products. Be sure to wear appropriate protective clothing, gloves and safety glasses when working with any tools. Installer should check for and relocate all electrical wiring within the proposed installation area, as needed (be sure to disconnect all electric power before working with any electrical wiring and follow all applicable local electrical codes and safety procedures).

Brick and Masonry Applications

Use a combination of masonry fasteners and PL Premium Adhesive to fasten Fypon products to brick or masonry structures. Countersink the fasteners and apply a non-shrinking filler in the indentations. Allow the wood filler to cure, then sand filled area flush. Touch up with paint.

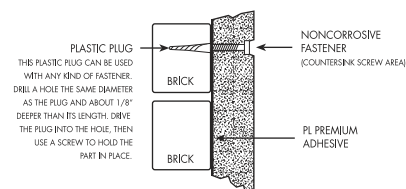

Finishing Options

Moulded of high-density urethane foam, Fypon moulded millwork products have an in-mold barrier coat, which becomes an integral part of the urethane foam as it cures.

After each piece is moulded and trimmed, we apply an exterior grade white primer paint with a built-in ultraviolet stabilizer.

Our products are impervious to moisture, so painted surfaces are not subject to the degree of chipping and peeling common with painted wood. Also, they are not subject to decay or insect damage.

PAINTING

Fypon products may be painted with any good quality latex or oil base paint. Usually one coat is all that is needed.

FAUX FINISHES

Our products are also suitable for many faux finishing techniques, including sponging, feathering, and antiquing using either oil base or latex paints.

WHITE COLOR MATCH – AVAILABLE AT SHERWIN-WILLIAMS®

To better service our customers nationwide, we have worked with Sherwin-Williams® to formulate a color and sheen match for our white paint that is applied at the factory. You can take this formulation to your local Sherwin-Williams dealer.

Formulation: Superior Exterior, Satin Latex

Paint Gallon Base: A89W51
 LI - 1/64
 WI - 6 oz.
 NI - 1/128
 Y3 - 1/128
 R1 or R4 - 1/64

STAINING

Fypon products that are noted as Woodgrain/Stainable may be stained. Apply a good quality, nonpenetrating stain (ZAR™, Olympic Overcoat™, etc.) with a 2" natural bristle brush. Begin applying stain in a circular motion, then feather the stain in the direction of the grain. For a darker finish, apply a heavy coat of stain with light pressure. For a lighter finish, apply a thin coat of stain with more pressure.

USING CORROSION-RESISTANT FASTENERS AND PL PREMIUM ADHESIVE

Always use corrosion-resistant mechanical fasteners (nails or screws) and PL Premium Adhesive when installing Fypon products. This combination provides a secure, long lasting bond. Countersink all fasteners about 1/8 inch and fill with exterior grade white spackle. If desired, sand any minor imperfections and topcoat with a quality exterior latex or oil base paint. Fypon exterior millwork installations should be finished using a quality, exterior grade silicone caulk to prevent water infiltration behind siding, windows and doors. Some exterior millwork installations, in particular new construction (before siding is applied) may require a J-channel and/or flashing to prevent water infiltration. Installers must determine which installation technique is best for the specific situation.

IMPORTANT:

Please read these installation guidelines thoroughly before beginning installation. Please note that these guidelines are provided only to assist with the installation of mouldings and millwork products. Modified procedures may be required in order to meet specific situations, unique applications and local building codes. The manufacturer does not under any circumstances warrant the installation of its products. Be sure to wear appropriate protective clothing, gloves and safety glasses when working with any tools. Installer should check for and relocate all electrical wiring within the proposed installation area, as needed (be sure to disconnect all electric power before working with any electrical wiring and follow all applicable local electrical codes and safety procedures).